

SPECIFICATIONS :
 Medium Light Freshwater
 120 yds / 8 lb Line Capacity
 5.8:1 Gear Ratio
 10.8 oz.
 Bearings: E7-2 - 6 BB; 1 RB
 E5-2 - 4 BB; 1 RB
 E3-2 - 2 BB; 1 RB
 E2-2 - 1 BB; 1 RB

FEATURES :
 Front Drag
 Tru-Balanced Rotor
 Balanced Handle
 Twist Reducer Line Roller
 Selective Continuous A/R
 Worm Gear Oscillation
 Spare Alum. Spool (E7-2 / E7-2A)
 Alum. Spool ("A" models w/ holes in skirt)
 Color: E7-2 - Light Silver
 E7-2A - Medium Brown
 E5-2 - Cream
 E5-2A - White
 E3-2 - Dark Grey
 E2-2 - Black

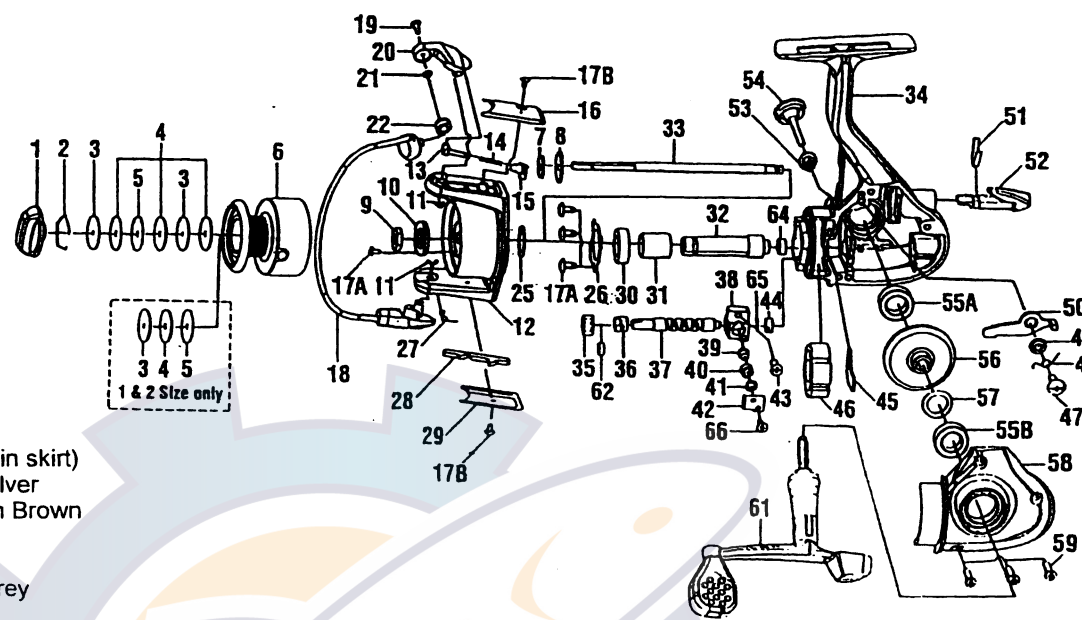

Key No.	E7-2 / A	E5-2 / A	E3-2	E2-2	Description	Price	Key No.	E7-2 / A	E5-2 / A	E3-2	E2-2	Description	P
1	FH332-02	FH332-01	FH332-02	FH332-03	Drag Knob	2.97	34	FH301-07	FH301-01	FH301-02	FH301-03	Body Assy.	1
1	FH332-10	FH332-09	N/A	N/A	Drag Knob	2.97	34	FH301-12	FH301-11	N/A	N/A	Body Assy.	1
2	AQ038-01	←	←	←	Drag Retainer	0.32	35	FH200-01	←	←	←	Level Wind Gear	1
3	TU080-01	←	←	←	Drag Washer "D"	1.16	36	N/A	TU202-01	←	←	Wm Shft Bushng (L)	0
4	GH033-01	←	←	←	Drag Washer "B"	2.68	36	GH202-01	N/A	N/A	N/A	Wm Shft Bearing (L)	7
5	TU081-01	←	←	←	Drag Washer "A"	1.16	37	FH201-01	←	←	←	Worm Shaft	2
6	FH321-04	FH321-01	FH321-02	FH321-03	Spool Assy.	7.21	38	ZQ204-01	←	←	←	Pawl Holder	3
6	FH321-09	←	N/A	N/A	Spool Assy.	7.21	39	TU207-01	←	←	←	Pawl	2
7	TU030-01	←	←	←	Click Gear Washer	0.96	40	UQ208-03	←	←	←	Pawl Collar	C
8	TU037-01	←	←	←	Click Gear Washer	1.22	41	RU209-01	←	←	←	Pawl Washer	0
9	RU006-01	←	←	←	Rotor Nut	0.93	42	FH205-01	←	←	←	Pawl Holder Retainer	1
10	TL065-01	←	←	←	Rotor "D" Washer	1.16	43	UQ100-03	←	←	←	Main Shaft Screw	0
11	GH034-01	←	←	←	E-Clip	0.32	44	N/A	GH203-01	←	←	Wm Shft Bushng (Rt)	0
12	FH009-04	FH009-01	FH009-02	FH009-03	Rotor	7.85	44	GH202-02	N/A	N/A	N/A	Wm Shft Bearmg (Rt)	7
12	FH009-11	FH009-10	N/A	N/A	Rotor	7.85	45	TU206-01	←	←	←	Worm Shaft Retainer	1
13	QL031-01	←	←	←	Bail Spring Shaft	0.27	46	GH074-01	←	←	←	Clutch Bearing	1
14	KQ049-05	←	←	←	Bail Spring	0.32	46	RU074-01	←	←	←	Use GH074-01 (clutch bearing) & TU052-01 (bearing sleeve)	
15	QL020-01	←	←	←	Bail Spring Holder	0.32	47	GH077-01	←	←	←	A/R Pawl Screw	0
16	FH087-04	FH087-01	FH087-02	FH087-03	Arm Lvr Spring Cvr	2.67	48	TU061-01	←	←	←	A/R Pawl Spring	0
16	FH087-11	FH087-10	N/A	N/A	Arm Lvr Spring Cvr	2.67	49	TU091-01	←	←	←	A/R Pawl Post	1
17A	UQ057-01	←	←	←	Screw	0.32	50	TU063-01	←	←	←	A/R Pawl	1
17B	UQ057-03	←	N/A	N/A	Screw	0.32	51	GH089-01	←	←	←	A/R Lever Spring	1
18	FH347-04	FH347-01	FH347-02	FH347-03	Bail Assy.	3.92	52	GH090-03	←	GH090-02	←	A/R Lever	2
18	FH347-12	FH347-11	N/A	N/A	Bail Assy.	3.92	52	GH090-05	GH090-04	N/A	N/A	A/R Lever	2
19	AQ108-01	←	←	←	Line Slider Screw	0.31	53	RU105-01	←	←	←	Handle Cap Washer	0
20	ZQ007-04	ZQ007-01	ZQ007-02	ZQ007-03	Arm Lever	2.39	54	ZQ073-01	←	←	←	Handle Cap Screw	1
20	ZQ007-11	ZQ007-10	N/A	N/A	Arm Lever	2.39	55A	BL157-01	←	N/A	N/A	Ball Bearing (Body)	5
21	GU105-25	←	←	←	Line Roller Washer	0.32	55A	N/A	N/A	GH013-01	←	Bushing (Body)	1
22	TU004-02	←	N/A	N/A	L/Roller w/Bearing	6.90	55B	BL157-01	←	←	N/A	B. Bearing (Body Cvr)	5
23	N/A	N/A	GH016-01	←	Line Roller Bushing	1.16	55B	N/A	N/A	N/A	GH013-01	Bushing (Body Cvr)	1
24	N/A	N/A	GH004-02	←	Line Roller	4.69	56	FH012-01	←	←	←	Drive Gear	1
25	GU105-12	←	←	←	Rotor Washer	0.32	57	GU105-13	←	←	←	Adjust Washer	0
26	N/A	N/A	N/A	N/A	Bearing Plate	—	58	FH023-07	FH023-01	FH023-02	FH023-03	Side Cover	5
27	GH049-01	←	←	←	Kick Lever Spring	0.32	58	FH023-11	FH023-10	N/A	N/A	Side Cover	5
28	FH019-01	←	←	←	Kick Lever	1.11	59	KQ057-01	←	←	←	Side Cover Screws	0
29	FH024-04	FH024-01	FH024-02	FH024-03	Kick Lever Cover	2.76	59	KQ057-03	←	N/A	N/A	Side Cover Screws	0
29	FH024-11	FH024-10	N/A	N/A	Kick Lever Cover	2.76	61	FH318-03	FH318-01	FH318-02	FH318-03	Handle Assy.	11
30	BL157-01	←	←	←	Pinion Ball Bearing	5.57	61	FH318-06	FH318-05	N/A	N/A	Handle Assy.	11
31	TU052-01	←	←	←	Bearing Sleeve	2.76	62	GH212-01	N/A	N/A	N/A	Worm Shaft Collar	1
31	RU139-01	→→→ Use TU052-01 (bearing sleeve) & GH074-01 (clutch bearing)					64	RU141-01	←	←	←	Pinion Bushing	1
32	FH011-01	←	←	←	Pinion Gear	3.55	65	GU105-31	←	←	←	Worm Shaft Washer	0
33	FH015-01	←	←	←	Main Shaft	2.60	66	GH123-01	←	←	←	Plate Screw	0

☒ = Special parts for E7-2A and E5-2A.

△ = Send Key No.'s 38, 41, 42, and 66 if any of these are ordered.

☐ = Send Key No.'s 53, 54, and 61 if either part is ordered.

▲ = Both parts must be shipped together if either one is ordered.